

Side Channels - Installation Instructions

Please follow these Installation Instructions

You will need a pencil, tape measure, drill, screwdriver, pliers, and appropriate fasteners.

Step 1. ADJUSTING THE SIDE CHANNEL FOR INSTALLATION

Place the side channel into the window frame, window molding or wall area to be mounted. Mark locations inside the channel for drilling.

Note: Trimming the side channel may be necessary for a proper fit.

Note: Top view shown.

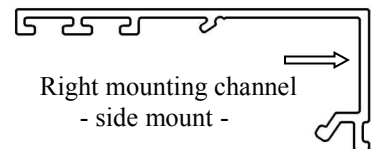
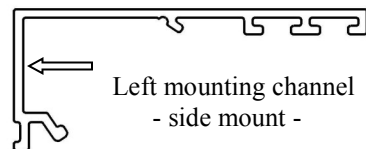
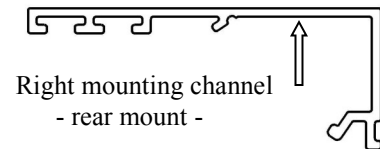
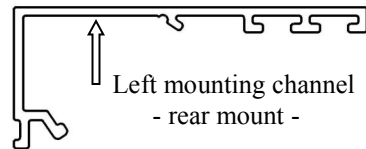

Step 2. INSTALL SIDE CHANNELS

Attach the mounting channel with screws.

Note: Top view shown.

INSIDE MOUNT INSTALLATION

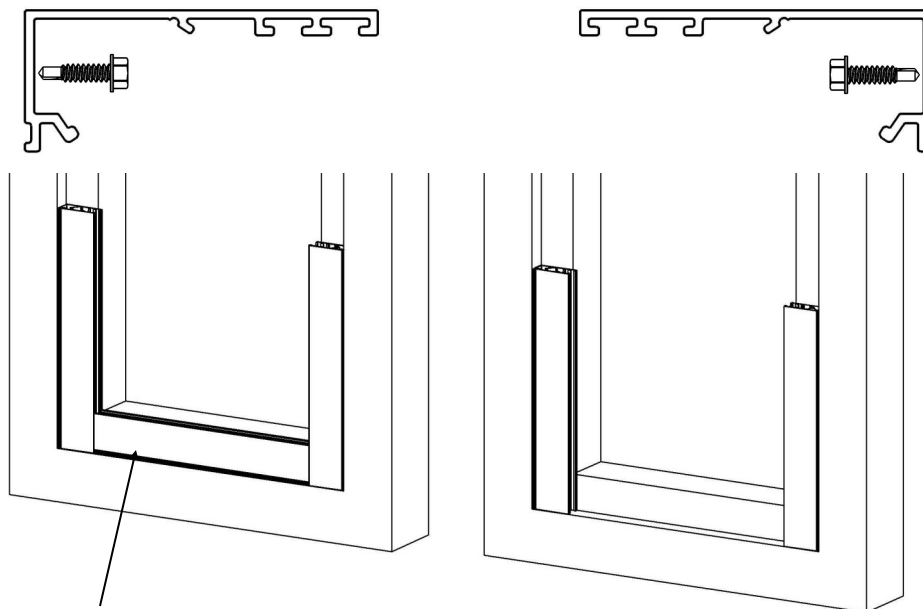

Sill channel optional
at additional cost

Side channels installed on the **inside**
frame of the window

Side Channels - Installation Instructions

OUTSIDE MOUNT INSTALLATION

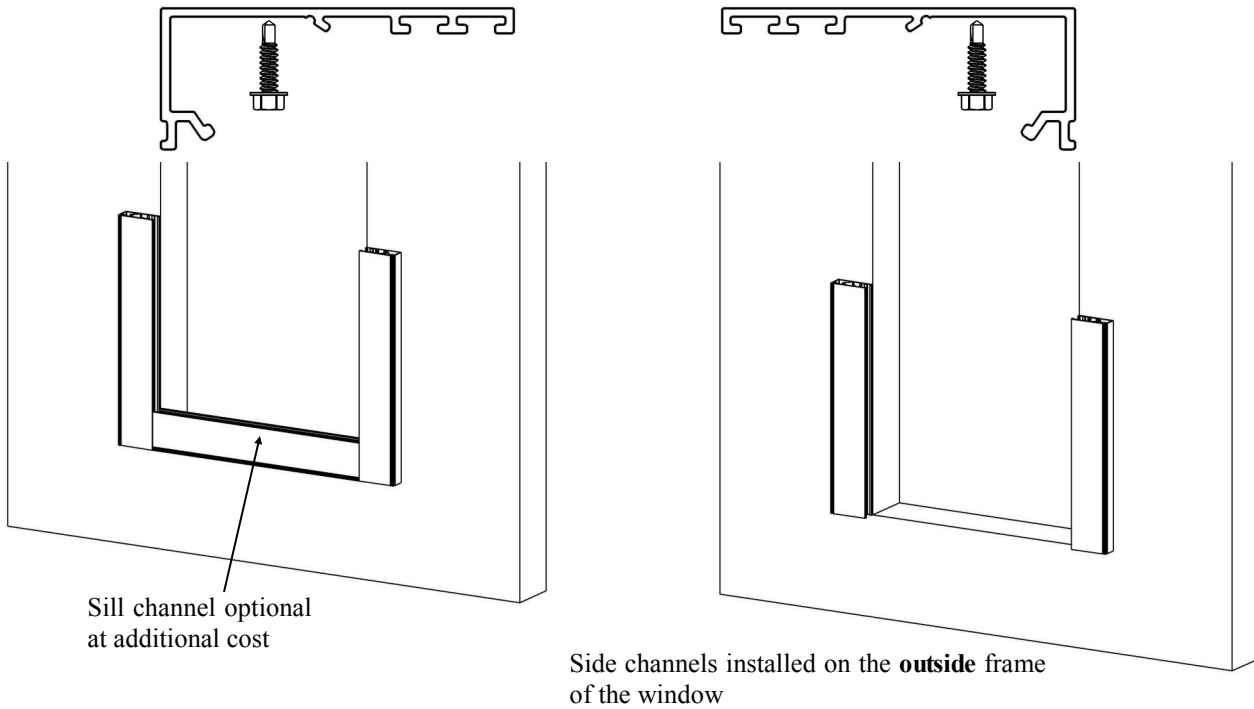

Step 3. ATTACH FRONT CHANNELS

Place the front channel into the mounting clip and rotate channel until it snaps into mounting channel.

Note: Top view shown.

